

Ordering Information

RF228-X XX X X X M AXX

HEIGHT OF HOUSING	1:Single-Row 28:2.8mm	NO. OF PINS PER ROW	0:No Pitch 1~40P 2~40P	A=1u" B=2u" C=5u" D=10u" E=15u" F=30u"	A:PBT B:PA6T C:PA9T D:LCP G:PPS	LENGTH OF TERMINAL

SMT socket connector:single row
perpendicular mount
Availability from:2 to 40 contacts
Standard number of contacts 40

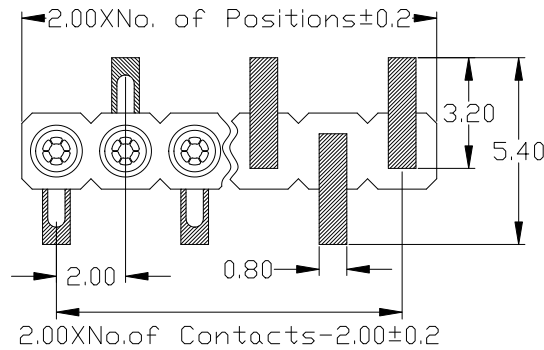
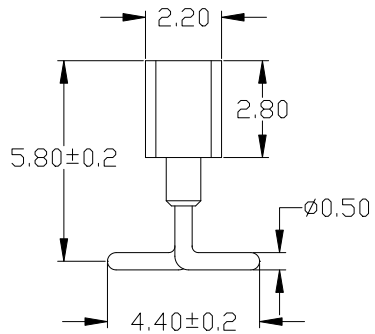

Specifications

SMT socket connector:single row
perpendicular mount
Availability from:4 to 80 contacts
Standard number of contacts 80

Insulator : Black glass filled polyester PPS-GF30-FR
Flammability : UL94V-0
Sleeve : Brass CuZn 36Pb3(36000)
Contact cusp (6 finger) : Beryllium copper (C17200)
Mating pin Ø : 0.40 to 0.66 mm or 0.50SQ
Forces : (polished steel gauge Ø0.46mm)
-Insertion : 0.7 N typ.
-Withdrawal : 0.4N typ.
Mechanical life : min 500 cycles
Rated current : 3Amp
Contact resistance: Max 10mΩ
Dielectric resistance : Min 1000V_{RMS}
Coplanarity SMT terminations : max 0.1mm(measured on 25 mm long connectors)

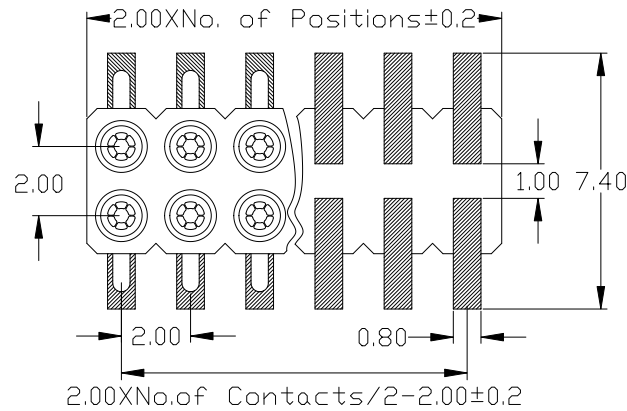
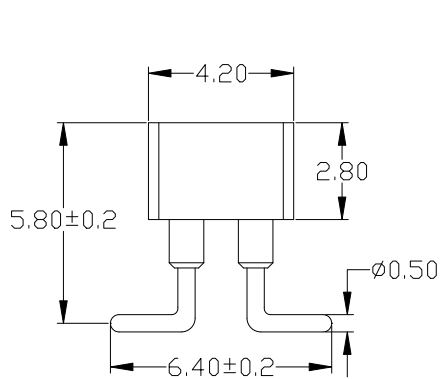

					OPERATION		SCALE		Fit		上海高霖电子有限公司		
					X.X	±0.25	UNIT		MM				
					X.XX	±0.20	SIZE	A4	DESIGN	卢小强	PART NO.	RF228-XXXXXXXXXX1	
					X.XXX	±0.10	SHEET	1/1	CHECK		TITLE:	2.0圆孔排母 塑高2.8 SMT	
					Angle	±3°	PROJ.	☉	APPROVE		Customer No.		
REV	DATE	MODIFICATION DESCRIPTION	CHANGE	APPROVE	DIM	TOL							